

89118

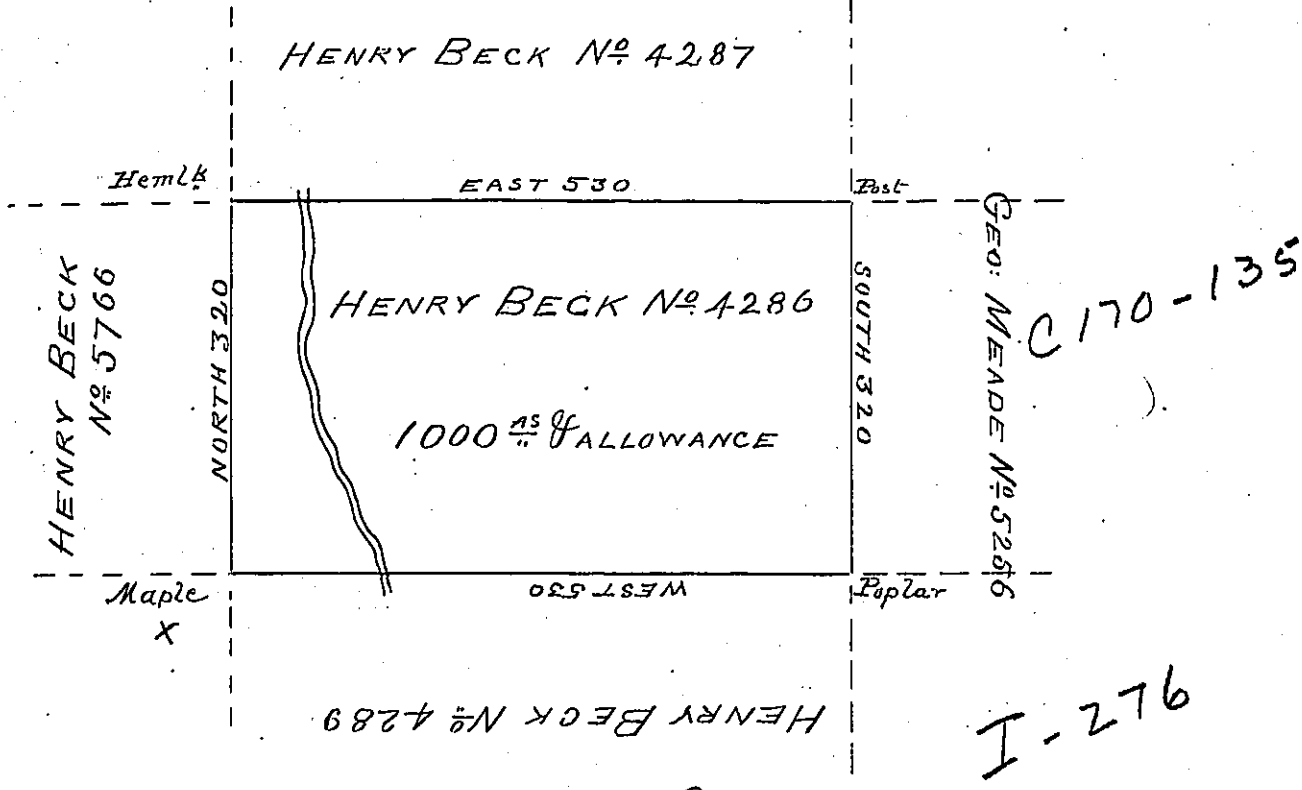

89117

Situate on a run that enters into the West Branch of Susquehanna, near the Mouth of Chest Creek, in the last purchase, District No. 4. Containing One thousand acres and the usual allowance of six Per Cent for roads &c. Surveyed & surveyed the 11th Day of September 1798, by James Hunter Esq: late Pa. Deputy Surveyor, in pursuance of a warrant granted to Henry Beck No. 4286, dated the 9th Day of December 1793.

Examined and Certified this 9th day of June 1803
 by *James Johnston D.S.*
Geo Sam Cochran Esq
 Surveyor Genl of Penna.

IN TESTIMONY that the above is a copy of the original remaining on file in the Department of Internal Affairs of Pennsylvania, made conformably to an Act of Assembly approved the 16th day of February, 1833, I have hereunto set my Hand and caused the Seal of said Department to be affixed at Harrisburg, this *twenty eighth* day of *December* 1903.

Geo B Perry
 Secretary of Internal Affairs.